

HS SENSOR REPLACEMENT



The microprocessor-profiled capacitive HS element can be replaced in the field without calibration.

PRODUCT IDENTIFICATION

	Accuracy	NIST
HS	<input type="checkbox"/>	<input type="checkbox"/>
	1 = 1%*	N = NIST (1% and 2% models only)
	2 = 2%	X = None (2%, 3%, and 5% models only)
	3 = 3%	
	5 = 5%	

ATTENTION HS sensor elements are sold as open devices. Observe handling precautions for static sensitive devices to avoid damage to the circuitry which would not be covered under the factory warranty.

* 1% HS sensors used in outdoor applications are limited by the device to 2% accuracy.

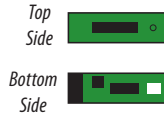

INSTALLATION

For all unit types, ensure that the four HS pin holes are inserted fully onto the unit pin connectors.

Humidity Outdoor and Duct Units

1. Disconnect power to the unit.
2. Remove probe from junction box by loosening black swage nut and sliding out.
3. Unscrew filter on tip of probe. Set filter aside.
4. Remove HS element by gently pulling from pin connector. Do not attempt to remove temperature sensor adjacent to HS element (if equipped).
5. Place new HS element onto pin connector. Orient as shown, or unit will not function (filter will not screw on if HS is inserted incorrectly).
6. Replace filter. Re-insert probe into junction box and tighten swage nut.

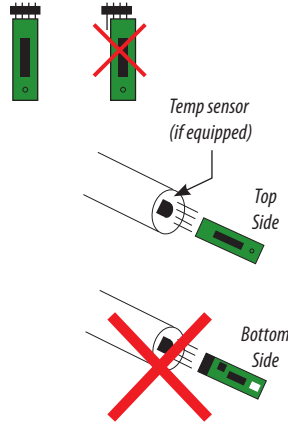

HS SENSOR REPLACEMENT



The microprocessor-profiled capacitive HS element can be replaced in the field without calibration.

PRODUCT IDENTIFICATION

	Accuracy	NIST
HS	<input type="checkbox"/>	<input type="checkbox"/>
	1 = 1%*	N = NIST (1% and 2% models only)
	2 = 2%	X = None (2%, 3%, and 5% models only)
	3 = 3%	
	5 = 5%	

ATTENTION HS sensor elements are sold as open devices. Observe handling precautions for static sensitive devices to avoid damage to the circuitry which would not be covered under the factory warranty.

* 1% HS sensors used in outdoor applications are limited by the device to 2% accuracy.

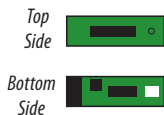

INSTALLATION

For all unit types, ensure that the four HS pin holes are inserted fully onto the unit pin connectors.

Humidity Outdoor and Duct Units

1. Disconnect power to the unit.
2. Remove probe from junction box by loosening black swage nut and sliding out.
3. Unscrew filter on tip of probe. Set filter aside.
4. Remove HS element by gently pulling from pin connector. Do not attempt to remove temperature sensor adjacent to HS element (if equipped).
5. Place new HS element onto pin connector. Orient as shown, or unit will not function (filter will not screw on if HS is inserted incorrectly).
6. Replace filter. Re-insert probe into junction box and tighten swage nut.

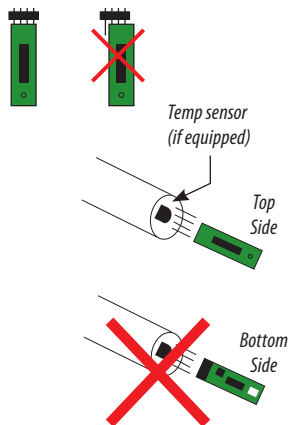

HS SENSOR REPLACEMENT



The microprocessor-profiled capacitive HS element can be replaced in the field without calibration.

PRODUCT IDENTIFICATION

	Accuracy	NIST
HS	<input type="checkbox"/>	<input type="checkbox"/>
	1 = 1%*	N = NIST (1% and 2% models only)
	2 = 2%	X = None (2%, 3%, and 5% models only)
	3 = 3%	
	5 = 5%	

ATTENTION HS sensor elements are sold as open devices. Observe handling precautions for static sensitive devices to avoid damage to the circuitry which would not be covered under the factory warranty.

* 1% HS sensors used in outdoor applications are limited by the device to 2% accuracy.

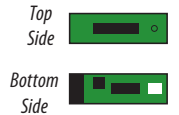

INSTALLATION

For all unit types, ensure that the four HS pin holes are inserted fully onto the unit pin connectors.

Humidity Outdoor and Duct Units

1. Disconnect power to the unit.
2. Remove probe from junction box by loosening black swage nut and sliding out.
3. Unscrew filter on tip of probe. Set filter aside.
4. Remove HS element by gently pulling from pin connector. Do not attempt to remove temperature sensor adjacent to HS element (if equipped).
5. Place new HS element onto pin connector. Orient as shown, or unit will not function (filter will not screw on if HS is inserted incorrectly).
6. Replace filter. Re-insert probe into junction box and tighten swage nut.

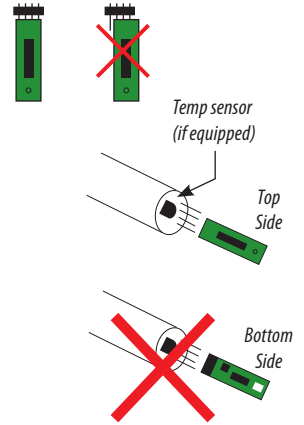

HS SENSOR REPLACEMENT



The microprocessor-profiled capacitive HS element can be replaced in the field without calibration.

PRODUCT IDENTIFICATION

	Accuracy	NIST
HS	<input type="checkbox"/>	<input type="checkbox"/>
	1 = 1%*	N = NIST (1% and 2% models only)
	2 = 2%	X = None (2%, 3%, and 5% models only)
	3 = 3%	
	5 = 5%	

ATTENTION HS sensor elements are sold as open devices. Observe handling precautions for static sensitive devices to avoid damage to the circuitry which would not be covered under the factory warranty.

* 1% HS sensors used in outdoor applications are limited by the device to 2% accuracy.

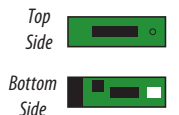

INSTALLATION

For all unit types, ensure that the four HS pin holes are inserted fully onto the unit pin connectors.

Humidity Outdoor and Duct Units

1. Disconnect power to the unit.
2. Remove probe from junction box by loosening black swage nut and sliding out.
3. Unscrew filter on tip of probe. Set filter aside.
4. Remove HS element by gently pulling from pin connector. Do not attempt to remove temperature sensor adjacent to HS element (if equipped).
5. Place new HS element onto pin connector. Orient as shown, or unit will not function (filter will not screw on if HS is inserted incorrectly).
6. Replace filter. Re-insert probe into junction box and tighten swage nut.

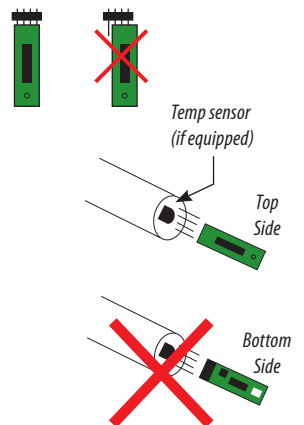

CO₂ Duct Units

1. Disconnect power to the unit.
2. Remove unit from duct.
3. Lift lid at end of probe.
4. Remove HS element by gently pulling from pin connector.
5. Place new HS element onto pin connector. Orient as shown, or unit will not function.
6. Close lid.
7. Replace unit in duct.

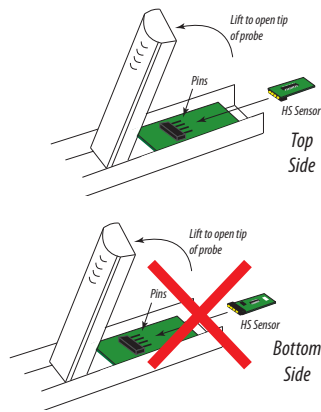

CO₂ Duct Units

1. Disconnect power to the unit.
2. Remove unit from duct.
3. Lift lid at end of probe.
4. Remove HS element by gently pulling from pin connector.
5. Place new HS element onto pin connector. Orient as shown, or unit will not function.
6. Close lid.
7. Replace unit in duct.

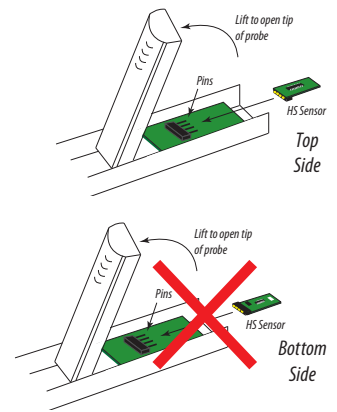

Wall Units

1. Disconnect power to the unit.
2. Remove faceplate.
3. Remove HS element by gently pulling from pin connector.
4. Place new HS element onto pin connector. Orient as shown, or unit will not function.
5. Replace faceplate.

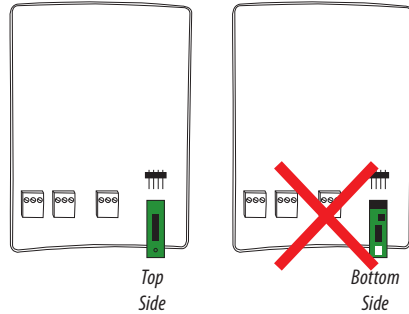

Wall Units

1. Disconnect power to the unit.
2. Remove faceplate.
3. Remove HS element by gently pulling from pin connector.
4. Place new HS element onto pin connector. Orient as shown, or unit will not function.
5. Replace faceplate.

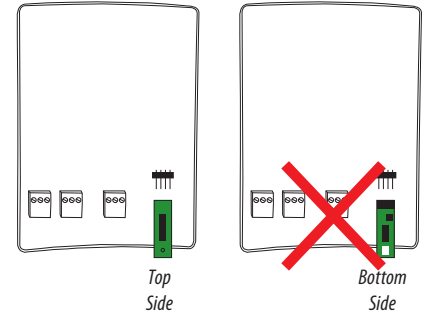

For further detail regarding humidity sensing devices, including safety information, refer to the full product installation guide at www.veris.com or contact Veris customer support at 1-800-354-8556.

Z205266-0B
08113

For further detail regarding humidity sensing devices, including safety information, refer to the full product installation guide at www.veris.com or contact Veris customer support at 1-800-354-8556.

Z205266-0B
08113

CO₂ Duct Units

1. Disconnect power to the unit.
2. Remove unit from duct.
3. Lift lid at end of probe.
4. Remove HS element by gently pulling from pin connector.
5. Place new HS element onto pin connector. Orient as shown, or unit will not function.
6. Close lid.
7. Replace unit in duct.

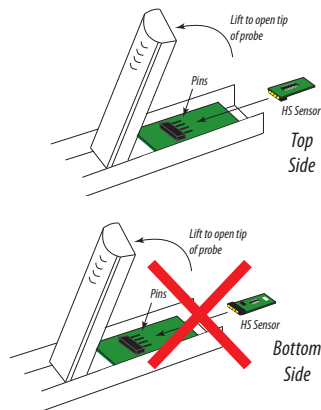

CO₂ Duct Units

1. Disconnect power to the unit.
2. Remove unit from duct.
3. Lift lid at end of probe.
4. Remove HS element by gently pulling from pin connector.
5. Place new HS element onto pin connector. Orient as shown, or unit will not function.
6. Close lid.
7. Replace unit in duct.

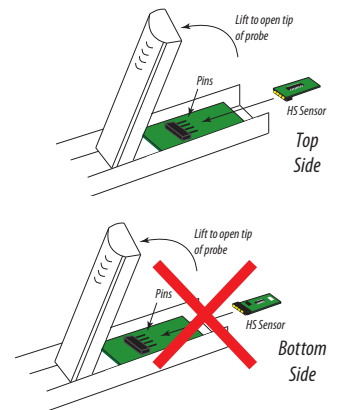

Wall Units

1. Disconnect power to the unit.
2. Remove faceplate.
3. Remove HS element by gently pulling from pin connector.
4. Place new HS element onto pin connector. Orient as shown, or unit will not function.
5. Replace faceplate.

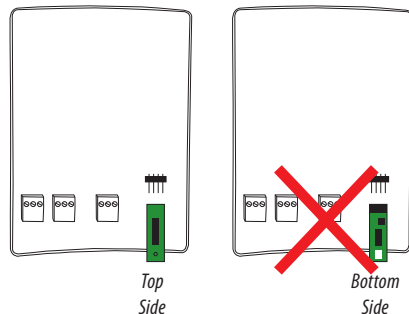

Wall Units

1. Disconnect power to the unit.
2. Remove faceplate.
3. Remove HS element by gently pulling from pin connector.
4. Place new HS element onto pin connector. Orient as shown, or unit will not function.
5. Replace faceplate.

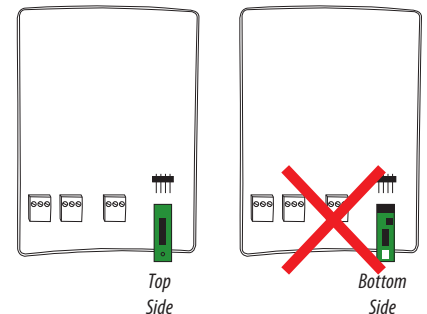

For further detail regarding humidity sensing devices, including safety information, refer to the full product installation guide at www.veris.com or contact Veris customer support at 1-800-354-8556.

Z205266-0B
08113

For further detail regarding humidity sensing devices, including safety information, refer to the full product installation guide at www.veris.com or contact Veris customer support at 1-800-354-8556.

Z205266-0B
08113