



Product Data

A/AFS-460 Pressure Switches

Pressure Switches



Attributes:

- Field adjustable setpoints
- 2 Year warranty
- RoHS compliant

Applications:

- General purpose proving switch
- Monitor flow
- Monitor filter blockage
- May be used to sense:
positive air pressure
negative air pressure
differential pressure

Product Description

The A/AFS-460 series differential pressure switches are general purpose proving switches designed to require a manual operator reset following actuation. These pressure switches can be used to sense either positive, negative, or differential air pressure in HVAC and Energy Management applications which require operator interface.

The A/AFS-460 has an input operating range of 0.40" to 12.0" w.c. with an adjustable setpoint range of 0.40" +/- 0.06" to 12" of w.c.. Each unit contains a diaphragm, calibration spring, and a snap-acting SPST-NC (Manual Reset) switch.

The sampling connections are located on each side of the diaphragm. They will accept a 0.25" O.D. rigid metallic tubing via the integral compression ferrule and nut. The enclosure cover guards against accidental contact with the "live switch" terminal screws and the setpoint adjustment screw. The A/AFS-460 also contains a 1/2" conduit knockout in the cover of the enclosure. Other options may be available upon request.

The A/AFS-460 is covered by ACI's Two (2) Year Limited Warranty, which is located in the front of ACI'S SENSORS & TRANSMITTERS CATALOG or can be found on ACI's web site, which is: www.workaci.com.

Product Specifications

Input Pressure Range	AFS-460 (0.40" to 12" w.c.)
Output	SPST -NC Contacts (Manual Reset)
Operating Temperature Range	-40 to 180°F (-40 to 82°C)
Electrical Rating	300 VA pilot duty @ 115 to 277 VAC 15 amps non-inductive to 277 VAC, 60 HZ
Maximum Pressure	0.5 psi (0.03 Bar)
Switch Differential	increasing from 0.02" +/- 0.01"wc to Approx 0.8" wc @ Maximum setpoint.
Setpoint	+0.08" wc @ Maximum Setpoint
Measured Media	Air, or combustion by-products that will not degrade silicon
Mounting Direction	Any Vertical Plane
Agency Approval	UL, FM, CSA, CE
Shipping Weight	1.2 lbs
Environmental Compliance	RoHS Compliant

Wiring Diagrams available at www.workaci.com



Made in the **USA**

Automation Components, Inc.
2305 Pleasant View Rd.
Middleton, WI 53562
PH: (608) 831-2585
FAX: (608) 831-7407

TEMPERATURE

RELATIVE HUMIDITY

PRESSURE

CURRENT

GAS SENSORS

ACCESSORIES

INTERFACE DEVICES

Dimensions

Side View

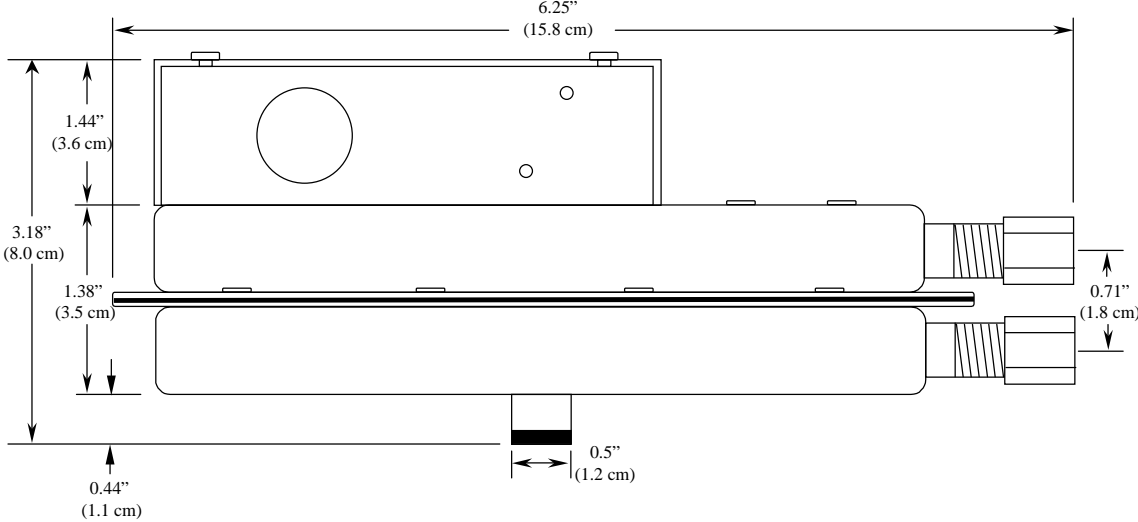

End View

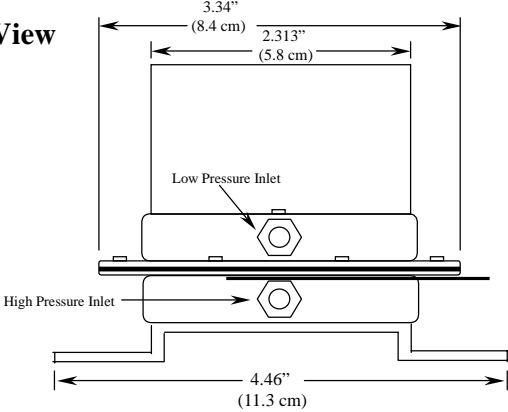

Ordering Information

Pressure Switch
A /AFS-460

Example: A/AFS-460

2305 Pleasant View Road Middleton, WI 53562
PH: (888) 967-5224 www.workaci.com